

# RECORD OF LAND CORNER MONUMENTATION

SOUTH 1/4 CORNER SECTION 32, T. 6 S., R. 28 E., W.M.

**ORIGINALLY ESTABLISHED BY:** Edward W. Sanderson, U.S. Deputy Surveyor

**CONTRACT NUMBER:** 368

**CONTRACT DATE:** September 7, 1880

**SUBSEQUENT SURVEYS:** Resurvey of the Exterior Lines of T.7S., R.28E., by Frank W. Campbell, U.S. Deputy Surveyor, under General Land Office Contract No. 521, dated January 8, 1885

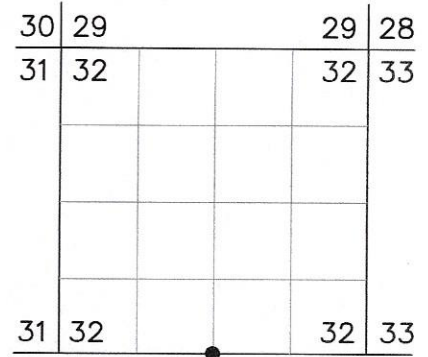

**ORIGINAL DESCRIPTION:** Set stone 14x12x7, in stone mound, for 1/4 sec. cor

**CAMPBELL'S 1885 DESCRIPTION:** The established 1/4 sec. cor. on S. boundary of Sec. 32, T6S, R28E

**EVIDENCE FOUND:** Found stone 14"x12"x7" in a 3 ft. diameter embedded mound of approximately 8 other stones. The call-size stone was rough and deteriorated, and I could find no marks. The search area was otherwise devoid of call-size stones. When comparing the measured distances against G.L.O. record distances to the nearest found corners east and west, the relationship was somewhat poor. However, the alignment was very good. I accept the position of the found stone as the best available evidence of the original corner.

**DESCRIPTION OF MONUMENTS AND ACCESSORIES SET AND METHODS USED:**

At the position of the found stone, I set a 5/8"x19" iron pin 8" into a drill hole in bedrock, and attached a 3 3/4" brass cap, marked as shown below. Built a 3 ft. diameter mound of stone around the monument to top of cap.

**From which, I SET NEW REFERENCE POINTS:**

- ▶ A 5/8"x 24" iron pin set flush, bears N.50°01'E., 19.98 ft., with attached 2" aluminum cap marked *RP 1 2022 PLS 69454*
- ▶ A 5/8"x 24" iron pin set flush, bears S.44°48'E., 30.09 ft., with attached 2" aluminum cap marked *RP 2 2022 PLS 69454*
- ▶ A 5/8"x 24" iron pin set flush, bears S.44°53'W., 30.03 ft., with attached 2" aluminum cap marked *RP 3 2022 PLS 69454*
- ▶ A 5/8"x 24" iron pin set flush, bears N.45°00'W., 63.99 ft., with attached 2" aluminum cap marked *RP 4 2022 PLS 69454*

CORNER MONUMENT MARKED:

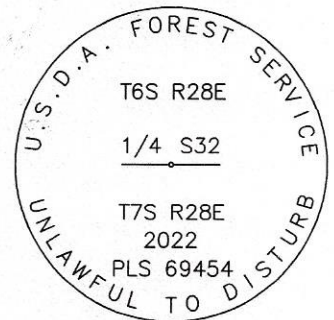

Deposited corner stone west and alongside the iron pin. Used RTK GPS to measure accessories. Bearings are geodetic, derived by GPS observation at the corner. Also set an aluminum guard post North 2.5 ft. from the monument, with USFS 54-9 sign attached.

**RESTORATION BY, STAMP AND DATE:**

Work Performed June 7, 2022 by:

Jason L. Hatfield, PLS  
Daniel B. Lee

USDA FOREST SERVICE  
NORTHEAST OREGON LAND ZONE  
1550 Dewey Avenue, Suite A  
Baker City, OR 97814  
(541) 523-1283

RECEIVED AND FILED  
GRANT COUNTY SURVEYOR

FEB 10 2023

BY:

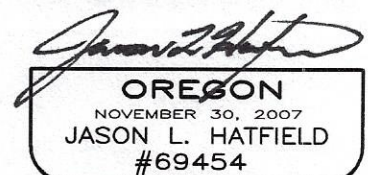
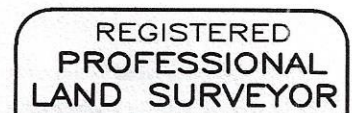

EXPIRES: 6/30/2023